

Measurement: measure inner volume of snail

For v1.6

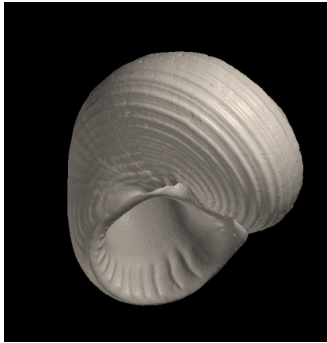

Try to measure inner volume of snail.

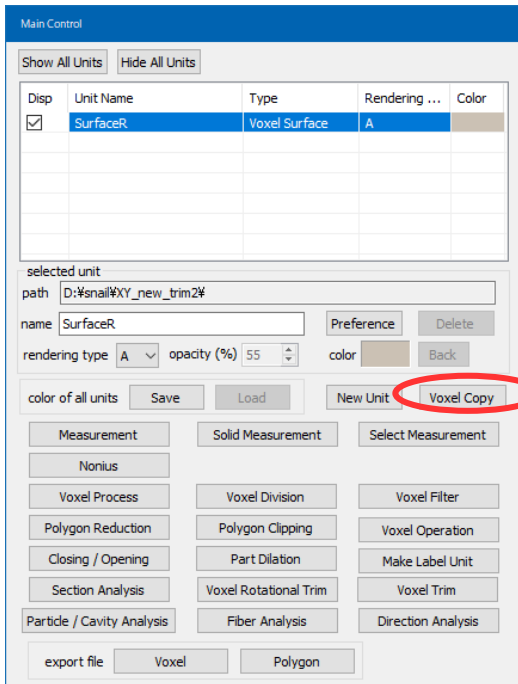

Change to "Surface Rendering" and press "Voxel Copy".

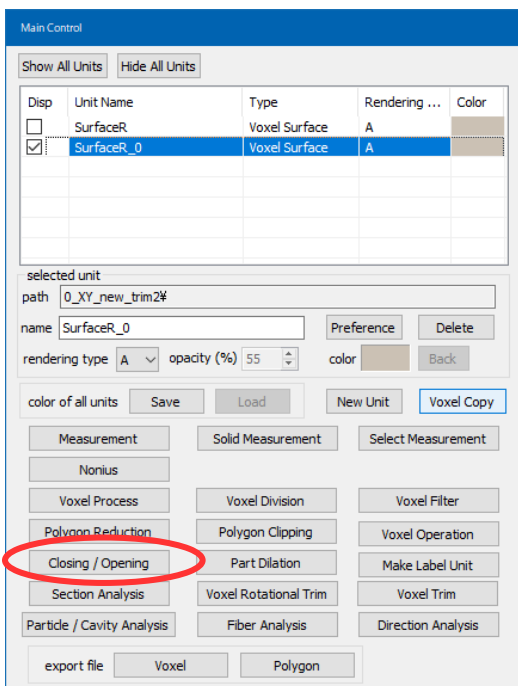

Voxel surface Unit is duplicated.
Set only copied one displayed and selected, press "Closing/Opening".

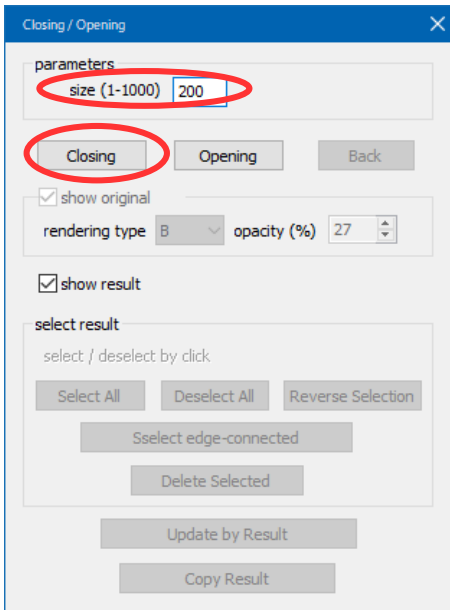

Set size to 200 and press "Closing".

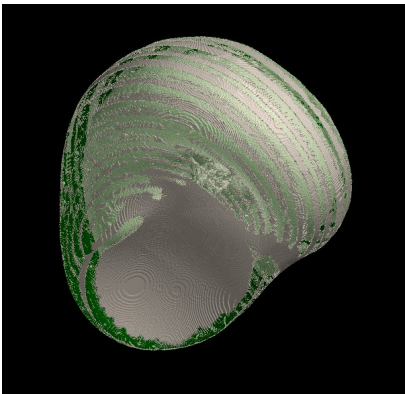

After closing, holes are filled.

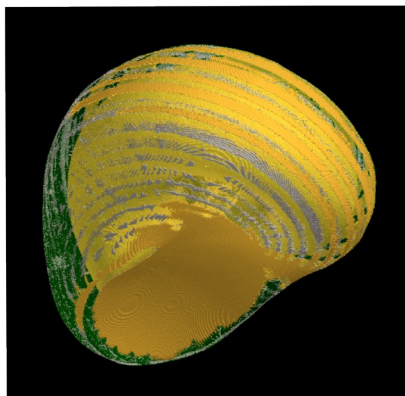

Select result by click, press "Update by Result".
Close "Closing / Opening" dialog.

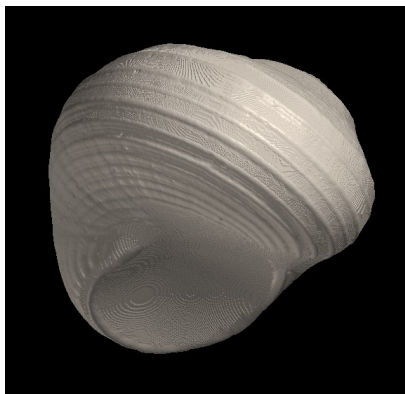

Next step is voxel subtraction.
Extract inner of snail.

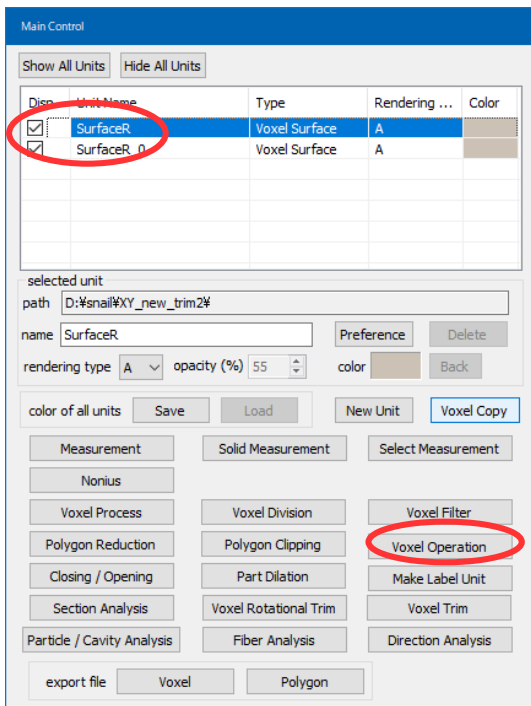

Set both original and copied Units displayed, press "Voxel Operation".

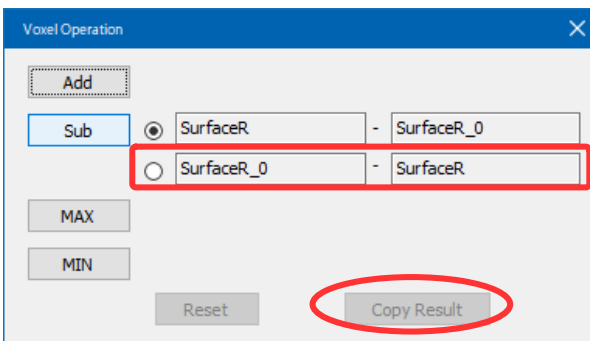

Subtract copied Unit from original. Press "Copy Result". Close dialog, then duplicate result Unit by "Voxel Copy".

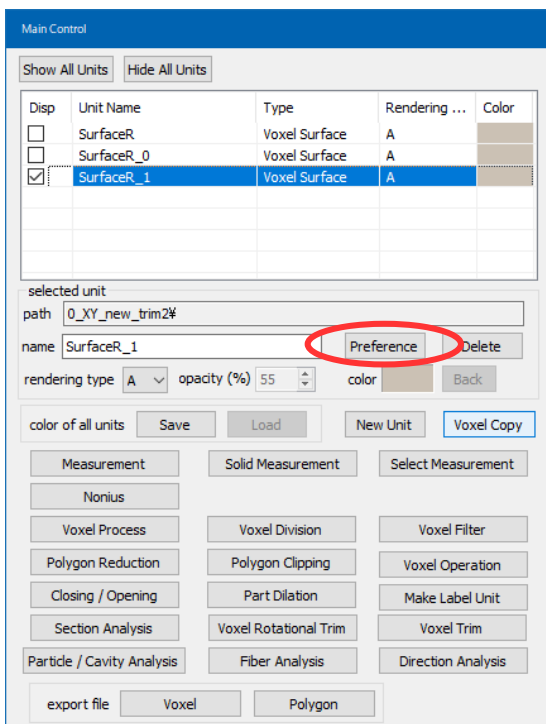

Select duplicated result Unit and press "Preference". Enter lower limit 1 and press "Apply".

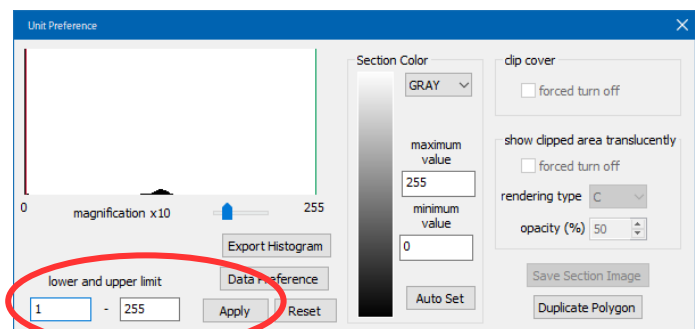

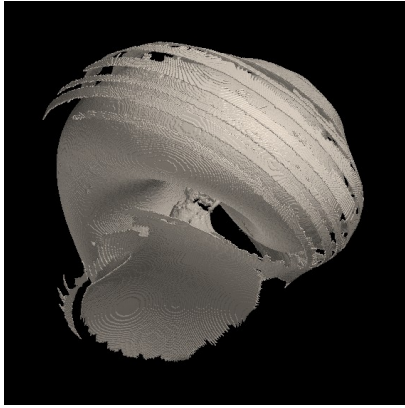

Subtracted result.
Next step is voxel process to remove unnecessary parts.

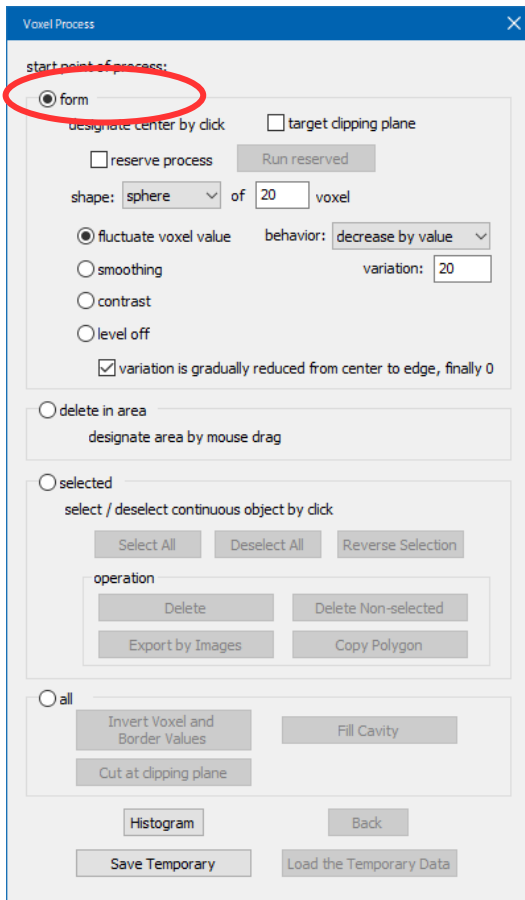

Press "Voxel Process".
Separate unnecessary outer parts by "form" manipulation.

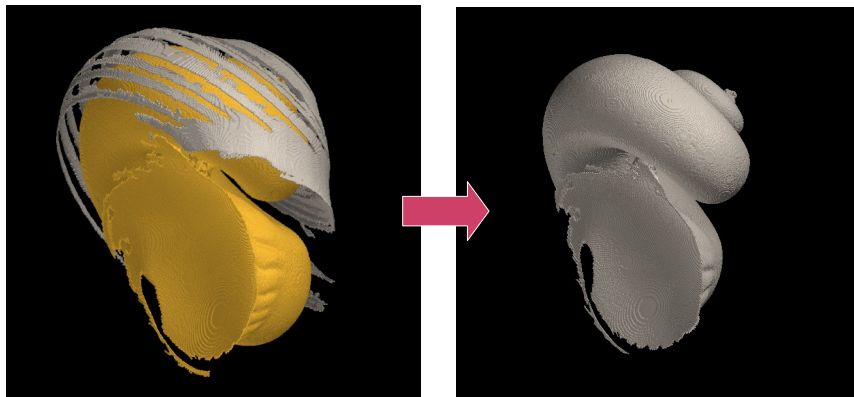
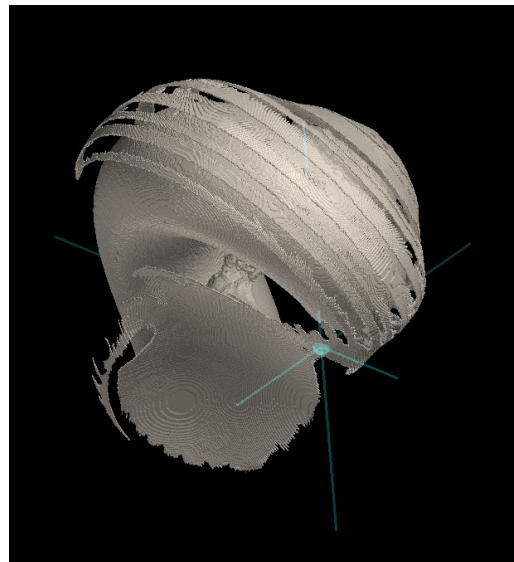

In "selected" manipulation,
select only inner part and press
"Delete Non-selected" to
remove unnecessary parts at
once.



Extraction is completed.
Last step is measurement.

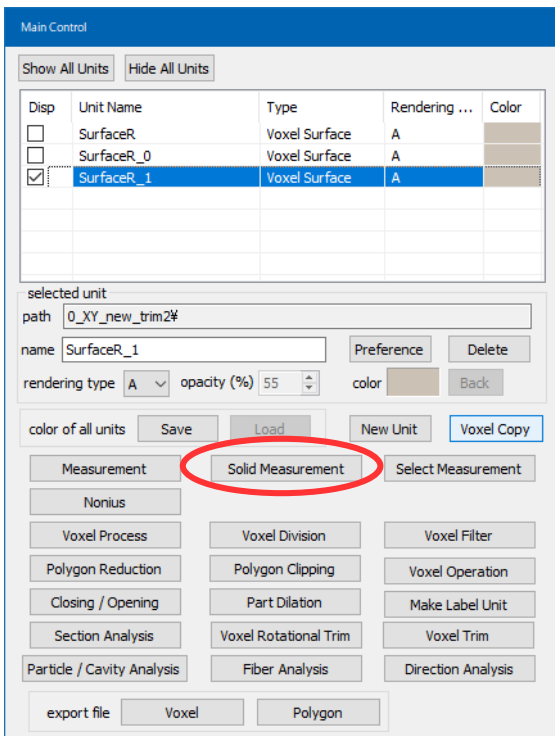

Press "Solid Measurement". Select extracted inner area to know its volume and so on.

